



P R O D U C T D A T A S H E E T

USA/CA: brightonBEST.com Europe: brightonBEST.org AU: brightonBEST.com.au NZ: brightonBEST.co.nz Brazil: brightonBEST.com.br

Hexagon Socket Set Screws Half Dog Point - Inch Series

1.0 Dimensions: ASME B18.3.

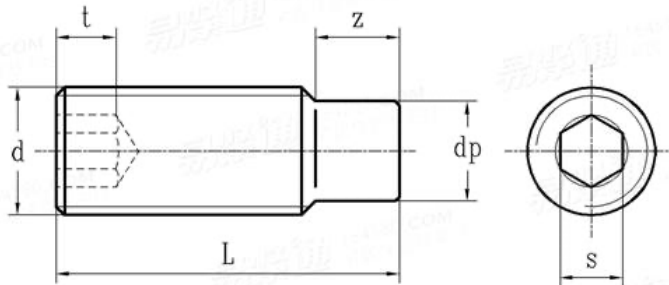

Nominal Size or Basic Product Diameter d	S	t	Half Dog Point Dimensions			
	Hexagon Socket Size	Key Engagement	Half Dog Point Diameter dp		Half Dog Point Length Z	
	Nom	Min	Max	Min	Max	Min
# 4	0.050	0.070	0.075	0.070	0.030	0.026
# 5	1/16	0.080	0.083	0.078	0.033	0.027
# 6	1/16	0.080	0.092	0.087	0.038	0.032
# 8	5/64	0.090	0.109	0.103	0.043	0.037
# 10	3/32	0.100	0.127	0.120	0.049	0.041
1/4	1/8	0.125	0.156	0.149	0.067	0.059
5/16	5/32	0.156	0.203	0.195	0.082	0.074
3/8	3/16	0.188	0.250	0.241	0.099	0.089
7/16	7/32	0.219	0.297	0.287	0.114	0.104
1/2	1/4	0.250	0.344	0.334	0.130	0.120
5/8	5/16	0.312	0.469	0.456	0.164	0.148
3/4	3/8	0.375	0.562	0.549	0.196	0.180

Notes: Thread Class of Fit: 3A.



BRIGHTON-BEST INTERNATIONAL



P R O D U C T D A T A S H E E T

USA/CA: brightonBEST.com Europe: brightonBEST.org AU: brightonBEST.com.au NZ: brightonBEST.co.nz Brazil: brightonBEST.com.br

Hexagon Socket Set Screws Half Dog Point - Inch Series

2.0 Mechanical Properties:

Set screws are subjected to compressive stress in applications. Tensile testing is not carried out on set screws.

2.1 Alloy Steel

Standard: ASTM F912

Hardness: HRC 45 to 53.

Hardness, Decarburization & Torsional strength test are the requisite mechanical properties to be met by the alloy steel socket set screws.

2.2 Stainless Steel

Standard: ASTM F880

Condition: CW

Hardness: 96 HRB to 33 HRC.

Hardness and Torsional strength test are the requisite mechanical properties to be met by the stainless steel socket set screws. Set screws (Stainless steel only) of sizes above 1/2 " are not subjected to torsional strength test.

The set screws will not have any markings.

3.0 Surface Finish:

Alloy Steel: Thermal Black Oxide Finish.

Stainless Steel: Passivated.