



FOUNDED 1925®

Proferred®

BBI TOOLS

The Quality You Know™

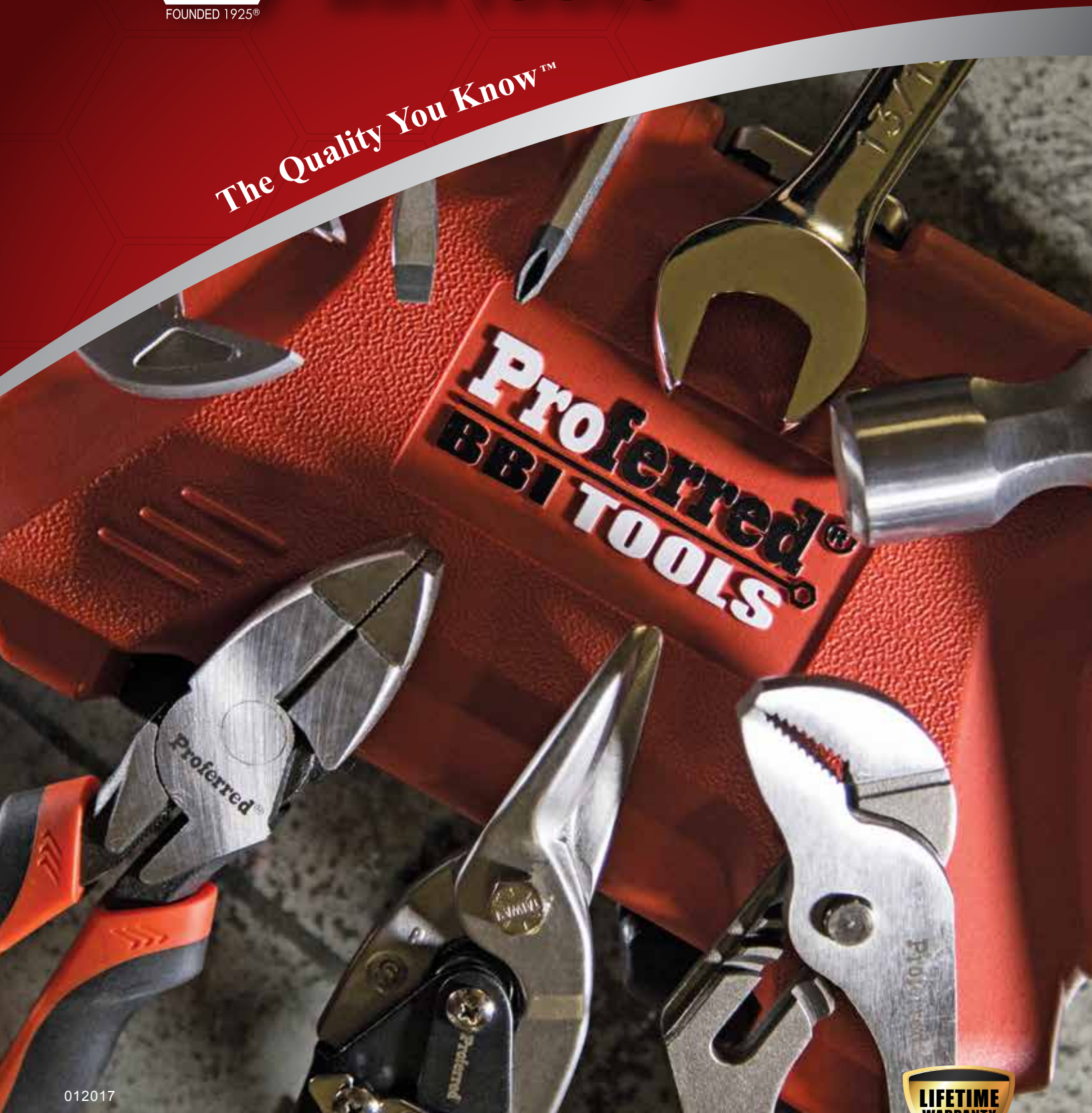

012017



www.brightonBEST.com ● 1-800-275-0050

COMING SOON



Superglue
Gel Knee Pads
Flashlights
Packing Tape
Duct Tape
Blue Painter's Tape
Vinyl Electrical Tape
Teflon Tape
Caution Tape



Full Range Cutting Tools



SIZE	DECIMAL	SIZE	DECIMAL	SIZE	DECIMAL	SIZE	DECIMAL
60	0.0400	27	0.1440	E	0.2500	33/64"	0.5156
59	0.0410	26	0.1470	F	0.2570	17/32 "	0.5312
58	0.0420	25	0.1495	G	0.2610	35/64 "	0.5469
57	0.0430	24	0.1520	17/64 "	0.2656	9/16 "	0.5625
56	0.0465	23	0.1540	H	0.2660	37/64 "	0.5781
55	0.0520	5/32 "	0.1562	I	0.2720	19/32 "	0.5938
54	0.0550	22	0.1570	J	0.2770	39/64 "	0.6094
53	0.0595	21	0.1590	K	0.2810	5/8 "	0.6250
1/16"	0.0625	20	0.1610	9/32 "	0.2812	41/64 "	0.6406
52	0.0635	19	0.1660	L	0.2900	21/32 "	0.6562
51	0.0670	18	0.1695	M	0.2950	43/64 "	0.6719
50	0.0700	11/64 "	0.1719	19/64 "	0.2969	11/16 "	0.6875
49	0.0730	17	0.1730	N	0.3020	45/64 "	0.7031
48	0.0760	16	0.1770	5/16 "	0.3125	23/32 "	0.7188
5/64 "	0.0781	15	0.1800	O	0.3160	47/64 "	0.7344
47	0.0785	14	0.1820	P	0.3230	3/4 "	0.7500
46	0.0810	13	0.1850	21/64 "	0.3281	49/64 "	0.7656
45	0.0820	3/16 "	0.1875	Q	0.3320	25/32 "	0.7812
44	0.0860	12	0.1890	R	0.3390	51/64 "	0.7969
43	0.0890	11	0.1910	11/32 "	0.3438	13/16 "	0.8125
42	0.0935	10	0.1935	S	0.3480	53/64 "	0.8281
3/32 "	0.0938	9	0.1960	T	0.3580	27/32 "	0.8438
41	0.0960	8	0.1990	23/64 "	0.3594	55/64 "	0.8594
40	0.0980	7	0.2010	U	0.3680	7/8 "	0.8750
39	0.0995	13/64 "	0.2031	3/8 "	0.3750	57/64 "	0.8906
38	0.1015	6	0.2040	V	0.3770	29/32 "	0.9062
37	0.1040	5	0.2055	W	0.3860	59/64 "	0.9219
36	0.1065	4	0.2090	25/64 "	0.3906	15/16 "	0.9375
7/64 "	0.1094	3	0.2130	X	0.3970	61/64 "	0.9531
35	0.1100	7/32 "	0.2188	Y	0.4040	31/32 "	0.9688
34	0.1110	2	0.2210	13/32 "	0.4062	63/64 "	0.9844
33	0.1130	1	0.2280	Z	0.4130	1"	1.0000
32	0.1160	A	0.2340	27/64 "	0.4219	1-1/16 "	1.0625
31	0.1200	15/64 "	0.2344	7/16 "	0.4375	1-1/8 "	1.1250
1/8 "	0.1250	B	0.2380	29/64 "	0.4531	1-3/16 "	1.1875
30	0.1285	C	0.2420	15/32 "	0.4688	1-1/4 "	1.2500
29	0.1362	D	0.2460	31/64 "	0.4844	1-5/16 "	1.3125
28	0.1405	1/4 "	0.2500	1/2 "	0.5000	1-3/8 "	1.3750
9/64 "	0.1406					1-1/2"	1.5000





Proffered®

BBI TOOLS



The Quality You Know™

AVIATION SNIPS	1
DRIVE BITS	1
NUTSETTERS	1
HAMMERS	2
HEX KEY SETS	2
PLIERS	3
RIVETERS	6
SCREWDRIVERS	6
SOCKETS	8
TACKERS, STAPLERS & STAPLES	13
TAPE MEASURES	13
UTILITY KNIFE	13
WRENCHES	14
HAND & TOOL WIPES	17
DRILL BIT SETS	17
SAWS	18
GLOVES	19
CABLE TIES	21
SAFETY GLASSES	21
REFLECTIVE VESTS	22



Proffered® BBI TOOLS



The Quality You Know™

AVIATION SNIP

STRAIGHT CUT, LEFT CUT, RIGHT CUT, NOTCH CUT, LONG CUT

Features

- Cuts up 1.2mm cold rolled steel or 0.7mm AISI-304 stainless steel.
- Meets or exceeds industry specification ANSI/ASME B107.16-1998.
- Quick and simple spring-free automatic latch design (one hand release) offers additional safety.
- Serrated blades, induction hardened.
- Drop forged Chrome-Molybdenum Alloy steel blades.



Part No.	Description
T02001	Proffered Aviation Snips Straight Cut
T02002	Proffered Aviation Snips Left Cut
T02003	Proffered Aviation Snips Right Cut

Part No.	Description
T02004	Proffered Aviation Snips Notch Cut
T02005	Proffered Aviation Snips Long Cut

20 PIECE PHILLIPS / SLOTTED DRIVE BITS

PHILLIPS SIZE: PH1x1" TO PH3x2"

SLOTTED SIZE: 4F-5Rx1" TO 20F-22Rx1-1/4"

Features

- S2 steel.
- Durable plastic storage case.



Part No.	Description
T50002	Proffered 20 Piece Phillips Drive Bits PH1x1", 1/4" Hex Shank
T50003	Proffered 20 Piece Phillips Drive Bits PH2x1", 1/4" Hex Shank
T50004	Proffered 20 Piece Phillips Drive Bits PH3x1", 1/4" Hex Shank
T50009	Proffered 20 Piece Phillips Drive Bits PH1x2", 1/4" Hex Shank
T50010	Proffered 20 Piece Phillips Drive Bits PH2x2", 1/4" Hex Shank
T50011	Proffered 20 Piece Phillips Drive Bits PH3x2", 1/4" Hex Shank
T52004	Proffered 20 Piece Slotted Drive Bits 4F-5R x 1", 1/4" Hex Shank Blade Thickness: 0.033", Blade Width: 0.182"
T52005	Proffered 20 Piece Slotted Drive Bits 5F-6R x 1", 1/4" Hex Shank Blade Thickness: 0.036", Blade Width: 0.232"
T52006	Proffered 20 Piece Slotted Drive Bits 6F-7R x 1", 1/4" Hex Shank Blade Thickness: 0.039", Blade Width: 0.245"

Part No.	Description
T52007	Proffered 20 Piece Slotted Drive Bits 8F-10R x 1", 1/4" Hex Shank Blade Thickness: 0.042", Blade Width: 0.279"
T52008	Proffered 20 Piece Slotted Drive Bits 10F-12R x 1", 1/4" Hex Shank Blade Thickness: 0.041", Blade Width: 0.281"
T52009	Proffered 20 Piece Slotted Drive Bits 12F-14R x 1", 1/4" Hex Shank Blade Thickness: 0.047", Blade Width: 0.327"
T52010	Proffered 20 Piece Slotted Drive Bits 14F-16R x 1", 1/4" Hex Shank Blade Thickness: 0.053", Blade Width: 0.374"
T52011	Proffered 20 Piece Slotted Drive Bits 16F-20R x 1-1/4", 5/16" Hex Bull Nose Shank Blade Thickness: 0.079", Blade Width: 0.500"
T52012	Proffered 20 Piece Slotted Drive Bits 20F-22R x 1-1/4", 5/16" Hex Bull Nose Shank Blade Thickness: 0.098", Blade Width: 0.551"

MAGNETIC NUTSETTERS

SIZE: 1/4"x1-3/4" TO 1/2"x1-3/4"

Features

- Chrome vanadium steel.
- Durable plastic storage case.



Part No.	Description
T51003	Proffered 5 Piece Magnetic Nutsetter 1/4" x 1-3/4", 1/4" Hex Shank
T51005	Proffered 5 Piece Magnetic Nutsetter 5/16" x 1-3/4", 1/4" Hex Shank

Part No.	Description
T51006	Proffered 5 Piece Magnetic Nutsetter 3/8" x 1-3/4", 1/4" Hex Shank
T51008	Proffered 5 Piece Magnetic Nutsetter 1/2" x 1-3/4", 1/4" Hex Shank

SIZE: 1/4"x4" TO 9/16"x4"

NEW

Features

- Chrome vanadium steel.
- Magnetic drive to hold the fastener.



Part No.	Description
T51303	Proffered Magnetic Nutsetter 1/4" Drive, 4", 1/4" Hex Shank
T51305	Proffered Magnetic Nutsetter 5/16" Drive, 4", 1/4" Hex Shank
T51306	Proffered Magnetic Nutsetter 3/8" Drive, 4", 1/4" Hex Shank

Part No.	Description
T51308	Proffered Magnetic Nutsetter 1/2" Drive, 4", 1/4" Hex Shank
T51309	Proffered Magnetic Nutsetter 9/16" Drive, 4", 1/4" Hex Shank



Proffered® BBI TOOLS



The Quality You Know™

CALIFORNIA FRAMING/RIPPING CLAW CURVED CLAW/DRYWALL/BALL PEEN HAMMERS

Features

- Head material 1055 medium carbon steel.
- Forged ball peen hammer head.
- Natural hickory handle.



Part No.	Description
T49001	Proffered 21 oz California Framing Hammer
T49013	Proffered 20 oz Ripping Claw Hammer
T49024	Proffered 16 oz Curved Claw Hammer

Part No.	Description
T49051	Proffered 12 oz Drywall Hammer
T49073	Proffered Hickory Ball Peen Hammer (12oz)
T49074	Proffered Hickory Ball Peen Hammer (16oz)

3 LB ONE PIECE FORGED CLUB HAMMER

Features

- Head material 1055 medium carbon steel.
- Head finish metallic finish, polished striking face.
- Designed to reduce vibration.
- Solid steel Head design creates less vibration.
- Double injection grip provides great comfort.

Part No.	Description
T49032	Proffered 3 LB One Piece Forged Club Hammer



16 oz RUBBER MALLET

Features

- Head material black natural rubber.
- Natural hickory handle.

Part No.	Description
T49063	Proffered 16 oz Rubber Mallet



LONG ARM BALL POINT HEX KEY SET

SAE: 0.05, 1/16, 5/64, 3/32, 7/64, 1/8, 9/64, 5/32, 3/16, 7/32, 1/4, 5/16, 3/8 INCH
METRIC: 1.5, 2, 2.5, 3, 4, 4.5, 5, 5.5, 6, 7, 8, 10 MM

Features

- Integration of ergonomic double-layer holder: Holder marked for easy identification of the dimensions.
- Unique rotating function.
- Up to 25° angle entry.

Part No.	Description
T35002	Proffered 13 Pieces Long Arm Ball Point Hex Key Set (SAE)

Part No.	Description
T35005	Proffered 12 Pieces Long Arm Ball Point Hex Key Set (Metric)



20 PIECE SHORT ARM HEX KEY SET

SAE: 1/16, 5/64, 3/32, 1/8, 5/32, 3/16, 7/32, 1/4, 5/16, 3/8 INCH
METRIC: 1.5, 2, 2.5, 3, 4, 5, 6, 7, 8, 10 MM

Features

- ABS storage case.
- Clear long lasting marking.
- Dual case: SAE and METRIC hex key in one box.

Part No.	Description
T36001	Proffered 20 Piece Short Arm Hex Key Set





8 PIECE T-HANDLE HEX KEY SET SAE 5/64"-3/8" NEW

Features

- Ergonomic smooth shape.
- Size identification molded handle.
- Handles proportioned to size.
- Molded black soft t-grip handle for lasting comfort.
- Through hardened durability.
- Chrome vanadium steel (CR-V).
- SAE open stock.



Part No.	Description	Part No.	Description
T34001	PROFERRED 8 PIECE T-HANDLE HEX KEY SET (SAE 5/64"-3/8")		
T37001	Proffered T-Handle Hex Key 5/64"	T37005	Proffered T-Handle Hex Key 3/16"
T37002	Proffered T-Handle Hex Key 3/32"	T37007	Proffered T-Handle Hex Key 1/4"
T37003	Proffered T-Handle Hex Key 1/8"	T37008	Proffered T-Handle Hex Key 5/16"
T37004	Proffered T-Handle Hex Key 5/32"	T37009	Proffered T-Handle Hex Key 3/8"

8 PIECE T-HANDLE HEX KEY SET METRIC 2MM-10MM NEW

Features

- Ergonomic smooth shape.
- Size identification molded handle.
- Handles proportioned to size.
- Molded black soft t-grip handle for lasting comfort.
- Through hardened durability.
- Chrome vanadium steel (CR-V).
- Metric open stock.



Part No.	Description	Part No.	Description
T34101	PROFERRED 8 PIECE T-HANDLE HEX KEY SET (METRIC 2MM-10MM)		
T37101	Proffered T-Handle Hex Key 2.0mm	T37105	Proffered T-Handle Hex Key 5.0mm
T37102	Proffered T-Handle Hex Key 2.5mm	T37106	Proffered T-Handle Hex Key 6.0mm
T37103	Proffered T-Handle Hex Key 3.0mm	T37107	Proffered T-Handle Hex Key 8.0mm
T37104	Proffered T-Handle Hex Key 4.0mm	T37108	Proffered T-Handle Hex Key 10.0mm

ALL PURPOSE 7 IN 1 ANGLE NOSE PLIERS

LENGTH: 8"

Features

- Crimps & strips crimps 10-22 AWG terminals and connectors.
- Strips 10-14 AWG solid and 12-16 AWG wire.
- Bolt cutter #6, #8.
- Diamond tooth design allows for greater gripping ability.
- Induction-hardened cutting edges for hard & soft wire cutting.
- Angled head design allows for overall greater flexibility.
- Thumb lock: Locking mechanism on grip handles.
- Ergonomic: Anti-fatigue comfort grip.



Part No.	Description
T20101	Proffered All Purpose 7 in 1 Angle Nose Pliers



HIGH LEVERAGE HEAVY DUTY DIAGONAL PLIERS, TPR GRIP

LENGTH: 7", 8"

Features

- Special high leverage design for increased cutting power.
- Hardened cutting edge cuts various types of wires and extends cutting edge life cycle.
- Ergonomic: Anti-fatigue comfort grip.

Part No.	Description
T18002	Proffered 7" High Leverage Heavy Duty Diagonal Pliers, TPR Grip



Part No.	Description
T18003	Proffered 8" High Leverage Heavy Duty Diagonal Pliers, TPR Grip

DIAGONAL CUTTING PLIERS, TPR GRIP

LENGTH: 6"

Features

- Hardened cutting edge cuts various types of wires and extends cutting edge life cycle.
- Ergonomic: Anti-fatigue comfort grip.

Part No.	Description
T17001	Proffered 6" Diagonal Cutting Pliers, TPR Grip (Non-Heavy Duty)



HIGH LEVERAGE HEAVY DUTY LINEMAN'S PLIERS, TPR GRIP

LENGTH: 8.5", 9.5"

Features

- Superior diamond teeth design for greater gripping ability.
- Special high leverage design for increased cutting power.
- Hardened cutting edge cuts various types of wires.
- Ergonomic: Anti-fatigue comfort grip.

Part No.	Description
T15001	Proffered 8.5" High Leverage Heavy Duty Lineman's Pliers, TPR Grip



Part No.	Description
T15002	Proffered 9.5" High Leverage Heavy Duty Lineman's Pliers, TPR Grip

SIDE CUTTING LONG NOSE PLIERS, TPR GRIP

LENGTH: 6", 7"

Features

- Superior diamond teeth design allows for greater gripping ability.
- Hardened cutting edge cuts various types of wires.
- Ergonomic: Anti-fatigue comfort grip.

Part No.	Description
T19001	Proffered 6" Side Cutting Long Nose Pliers, TPR Grip



Part No.	Description
T19002	Proffered 7" Side Cutting Long Nose Pliers, TPR Grip

LONG NOSE PLIERS WITHOUT CUTTER, TPR GRIP

LENGTH: 6"

Features

- Special design improves access in tight and narrow spaces.
- Superior diamond teeth design allows for greater gripping ability.
- Ergonomic: Anti-fatigue comfort grip.

Part No.	Description
T20001	Proffered 6" Long Nose Pliers without Cutter, TPR Grip (Non-Heavy Duty)





SLIP JOINT PLIERS, TPR GRIP

LENGTH: 6.5", 8"

Features

- Two functioning positions adjustment lay-on and single rivet joint.
- Serrated jaws.
- Ergonomic: Anti-fatigue comfort grip.

Part No.	Description
T21001	Proffered 6.5" Slip Joint Pliers, TPR Grip



Part No.	Description
T21002	Proffered 8" Slip Joint Pliers, TPR Grip

STRAIGHT JAW GROOVE JOINT PLIERS, COATED GRIP

LENGTH: 8", 10", 12", 16", 20"

Features

- Wide range of jaw adjustments and machined jaw grooves.
- Lay-on slip-joint.
- Non-slip cushion grips.

Part No.	Description
T16001	Proffered 8" Straight Jaw Groove Joint Pliers, Coated Grip
T16002	Proffered 10" Straight Jaw Groove Joint Pliers, Coated Grip
T16003	Proffered 12" Straight Jaw Groove Joint Pliers, Coated Grip



Part No.	Description
T16004	Proffered 16" Straight Jaw Groove Joint Pliers, Coated Grip
T16005	Proffered 20" Straight Jaw Groove Joint Pliers, Coated Grip

CURVED JAW LOCKING PLIERS NEW

Features

- Cr-Mo steel jaw, Cr-Mo steel handle.
- Body heat treated.
- Welding, nickel-plated.
- Easy release grip.
- Knurled torque adjustment screw.

Part No.	Description
T23007	Proffered Curved Jaw Locking Pliers 7"



Part No.	Description
T23010	Proffered Curved Jaw Locking Pliers 10"

C-CLAMPS LOCKING PLIERS WITH SWIVEL PADS NEW

Features

- Cr-Mo steel jaw, Cr-Mo steel handle.
- Body heat treated.
- Welding, nickel-plated.
- Easy release grip.
- Knurled torque adjustment screw.

Part No.	Description
T23211	Proffered C-Clamps Locking Pliers with Swivel Pads 11"



LONG NOSE JAW LOCKING PLIERS NEW

Features

- Cr-Mo steel jaw, Cr-Mo steel handle.
- Body heat treated.
- Welding, nickel-plated.
- Easy release grip.
- Knurled torque adjustment screw.
- With wire cutter.

Part No.	Description
T23409	Proffered Long Nose Jaw Locking Pliers 9"





Proffered® BBI TOOLS



The Quality You Know™

RETAINING SNAP RING PLIERS

NEW

Features

- Internal & external adjustable.
- Spring loaded handle.
- Intechangable tips, 45, 90 and straight-easy tip change set screw.
- Extra supply of tips included.

Part No.	Description
T22001	Proffered Retaining Snap Ring Pliers



STRIPPER/CRIMPER SPECIALTY PLIERS

NEW

Features

- Multi-purpose crimp tool for non-insulated lugs and terminals 10-22 AWG and pre-insulated 10-22 AWG, including a wire cutter, bolt cutter and wire stripper 10-22 AWG.
- Hardened carbon steel with black oxide finish.
- Precise CNC ground fabricated blades for consistent stripping and cutting.
- Crimping ignition terminals 7-8mm.
- Soften anti-slip cushioned grips.

Part No.	Description
T22011	Proffered Stripper/Crimper Specialty Pliers



HAND-OPERATED RIVET TOOL

NOSEPIECE: 3/32", 1/8", 5/32", 3/16"

Features

- Chrome steel and heat treated jaw & jaw case.
- High grade aluminum die cast housing.
- Carbon steel forged & heat treated handle.

Part No.	Description
T01002	HR-705 Proffered Hand Operated Rivet Tool 2 Jaw Nosepiece 3/32", 1/8", 5/32", 3/16"



HAND-OPERATED LEVER TOOL

NOSEPIECE: 1/8", 5/32", 3/16", 7/32", 1/4"

Features

- Lever design reduces physical strength for all rivet sizes.
- Grip design for comfort, safety and utility.

Part No.	Description
T01003	HR-730 Proffered Hand Operated Lever Tool 3 Jaw Nosepiece 1/8", 5/32", 3/16", 7/32", 1/4"

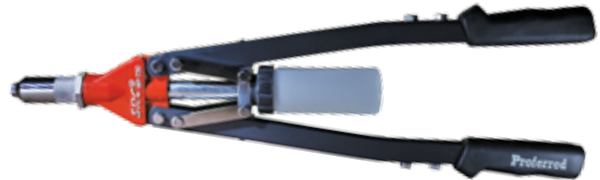

ACETATE CUSHION GRIP SCREWDRIVER

SLOTTED: 3/16"x4", 3/16"x6", 1/4"x4", 1/4"x6", 1/4"x8"

PHILLIPS: #1x4", #2x4", #2x6", #2x8", #3x6", #3x8"

Features

- Treated tip ensures perfect fit.
- Cellulose acetate material provides highest performance.
- Color coded handle for visual identification of Slotted and Phillips.
- TPV cushion grip provides slip resistance to chemical, oil and most solvents.

Part No.	Description
T25007	Proffered 3/16"x4" Acetate Cushion Grip Screwdriver Slotted (Red Acetate)
T25008	Proffered 3/16"x6" Acetate Cushion Grip Screwdriver Slotted (Red Acetate)
T25011	Proffered 1/4"x4" Acetate Cushion Grip Screwdriver Slotted (Red Acetate)
T25012	Proffered 1/4"x6" Acetate Cushion Grip Screwdriver Slotted (Red Acetate)
T25013	Proffered 1/4"x8" Acetate Cushion Grip Screwdriver Slotted (Red Acetate)
T25036	Proffered No.1x4" Acetate Cushion Grip Screwdriver Phillips (Blue Acetate)

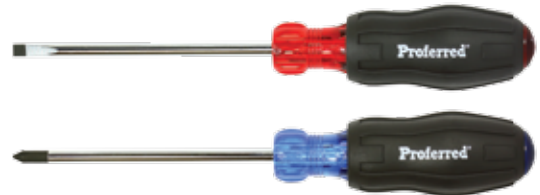

Part No.	Description
T25040	Proffered No.2x4" Acetate Cushion Grip Screwdriver Phillips (Blue Acetate)
T25041	Proffered No.2x6" Acetate Cushion Grip Screwdriver Phillips (Blue Acetate)
T25042	Proffered No.2x8" Acetate Cushion Grip Screwdriver Phillips (Blue Acetate)
T25044	Proffered No.3x6" Acetate Cushion Grip Screwdriver Phillips (Blue Acetate)
T25045	Proffered No.3x8" Acetate Cushion Grip Screwdriver Phillips (Blue Acetate)



Proffered® BBI TOOLS



The Quality You Know™

GO-THRU SCREWDRIVER

SLOTTED: 1/4"x4", 1/4"x6", 5/16"x6", 5/16"x8"
PHILLIPS: #2x4", #2x6", #3x6", #3x8"

Features

- Go-thru designed screwdriver can absorb vibration produced during impact.
- Hexagonal shape shank can withstand higher impact force.
- Dual material PP & TPV cushion grip provides slip resistance to chemical, oil and most solvents.
- Color coded handle for visual identification of Slotted and Phillips.

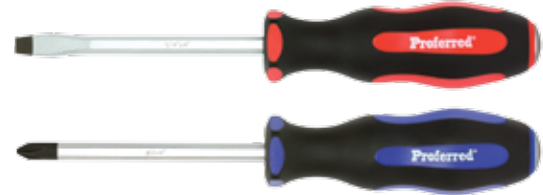

Part No.	Description
T26002	Proffered 1/4"x4" Go-Thru Screwdriver Slotted (Red Handle)
T26003	Proffered 1/4"x6" Go-Thru Screwdriver Slotted (Red Handle)
T26004	Proffered 5/16"x6" Go-Thru Screwdriver Slotted (Red Handle)
T26005	Proffered 5/16"x8" Go-Thru Screwdriver Slotted (Red Handle)

Part No.	Description
T26012	Proffered No.2x4" Go-Thru Screwdriver Phillips (Blue Handle)
T26013	Proffered No.2x6" Go-Thru Screwdriver Phillips (Blue Handle)
T26014	Proffered No.3x6" Go-Thru Screwdriver Phillips (Blue Handle)
T26015	Proffered No.3x8" Go-Thru Screwdriver Phillips (Blue Handle)

INSULATED (1000V) SCREWDRIVER

SLOTTED: 3/32"x3", 1/8"x4", 7/32"x5", 1/4"x6", 5/16"x7"
PHILLIPS: #0x2-3/8", #1x3-3/16", #2x4", #3x6"



Features

- Patented dual layer design provides greater protection against electric shock.
- Dual material PP & TPV cushion grip provides slip resistance to chemical, oil and most solvents.



Part No.	Description
T27004	Proffered 7/32"x5" Insulated (1000V) Screwdriver Slotted
T27005	Proffered 1/4"x6" Insulated (1000V) Screwdriver Slotted
T27006	Proffered 5/16"x7" Insulated (1000V) Screwdriver Slotted

Part No.	Description
T27022	Proffered No.1x3-3/16" Insulated (1000V) Screwdriver Phillips
T27023	Proffered No.2x4" Insulated (1000V) Screwdriver Phillips
T27024	Proffered No.3x6" Insulated (1000V) Screwdriver Phillips

4 PIECE INSULATED (1000V) SCREWDRIVER SET



Features

- Patented dual layer design provides greater protection against electric shock.
- Dual material PP & TPV cushion grip provides slip resistance to chemical, oil and most solvents.

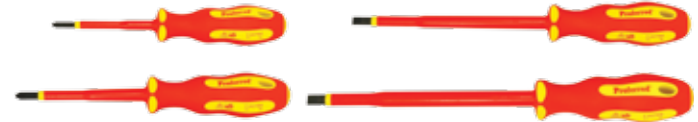

Part No.	Description
T28004	PROFFERED 4 PIECE INSULATED 1000V SCREWDRIVER SET Slotted: 1/4"x6", 5/16"x7", Phillips: No. 1x3-3/16", No. 2X4"

5 PIECE TORX® SCREWDRIVER SET

Features

- Treated tip ensures perfect fit.
- Cellulose acetate material provides highest performance.
- TPV cushion grip provides slip resistance to chemical, oil and most solvents.



Part No.	Description
T28002	PROFFERED 5 PIECE TORX® SCREWDRIVER SET T10x4", T15x4", T20x4", T25x4", T30x4"

5 IN 1 STUBBY BIT DRIVE SET

Features

- High torque coefficient will prevent the screwdriver from breaking when the tool is overstressed.
- Cellulose acetate material provides highest performance.
- TPV cushion grip provides slip resistance to chemical, oil and most solvents.



Part No.	Description
T29001	PROFFERED 5 IN 1 STUBBY BIT DRIVE SET Stubby Bit Holder Driver, Phillips Bits: #1, #2, Slotted Bits: 3/16", 1/4", Nut Driver: 1/4"



Proffered® BBI TOOLS



The Quality You Know™

6 PIECE ACETATE CUSHION GRIP SCREWDRIVER SET

Features

- Treated tip ensures perfect fit.
- Cellulose acetate material provides highest performance.
- Color coded handle for visual identification of Slotted and Phillips.
- TPV cushion grip provides slip resistance to chemical, oil and most solvents.



Part No.	Description
T28001	PROFERRED 6 PIECE SCREWDRIVER SET Slotted: 3/16"x3", 3/16"x6", 1/4"x4", 5/16"x6", Phillips: No.1x3", No.2x4"

7 PIECE HOLLOW SHANK NUT DRIVER SET

Features

- Treated tip ensures perfect fit.
- Cellulose acetate material provides highest performance.
- TPV cushion grip provides slip resistance to chemical, oil and most solvents.



Part No.	Description
T28003	PROFERRED 7 PIECE HOLLOW SHANK NUT DRIVER SET 3/16"x3", 1/4"x3", 5/16"x3", 11/32"x3", 3/8"x3", 7/16"x3", 1/2"x3"

9 IN 1 REGULAR BIT DRIVE SET

Features

- High torque coefficient will prevent the screwdriver from breaking when the tool is overstressed.
- Cellulose acetate material provides highest performance.
- TPV cushion grip provides slip resistance to chemical, oil and most solvents.



Part No.	Description
T29002	PROFERRED 9 IN1 REGULAR BIT DRIVE SET Regular Bit Holder Driver, Phillips Bits: #1, #2, Slotted Bits: 3/16", 1/4", TORX® Bits: T15, T20, Nut Drivers: 1/4", 5/16", 3/8"

14 IN 1 PRECISION BIT DRIVE SET

Features

- Bit holder driver's locking system holds the blade at desired length during use.
- Phillips
- Slotted
- TORX®
- Hex



Part No.	Description
T29003	PROFERRED 14 IN 1 PRECISION BIT DRIVE SET Phillips Bits: #000, #00, #0, Slotted Bits: 1/16", 5/64", 1/8", TORX® Bits: T5, T6, T7, T8, Hex Bits: 5/64", 3/32" 1/8", 5/32"

19 IN 1 RATCHETING SCREWDRIVER DRIVE SET

Features

- Torque the torque is above 390lbs-in.
- Ratchet: The ratchet permits high-speed action with grip adjustments and can be combined with popular driver ends.
- The perfect handle design allows the handle to disperse the pressure evenly when applying force.



Part No.	Description
T29004	PROFERRED 19 IN 1 RATCHETING SCREWDRIVER DRIVE SET Ratcheting Handle with Storage, Phillips Bits: #1, #2, #3, Slotted Bits: 3/16", 1/4", 5/16", TORX® Bits: T15, T20, T25, T30, Square Bits: #1, #2, Hex Bits: 1/8", 5/32", 3/16", 1/4", Nut Drivers: 1/4", 5/16", 7/16"

1/4" DRIVE STANDARD SOCKET MASTER SET-48 PIECE



Part No.	Description
S01001	PROFERRED 1/4" DRIVE STANDARD SAE-MT - 6 POINT SOCKET MASTER SET 48 PIECE
1/4" Drive SAE 6 Point Standard Socket 5/32", 3/16", 7/32", 1/4", 9/32", 5/16", 11/32", 3/8", 7/16", 1/2", 9/16"	Bits Set 1: T10, T15, T20, T25, T27, T30, T40, PH1, PH2, PH3
1/4" Drive Metric 6 Point Standard Socket 4mm, 4.5mm, 5mm, 5.5mm, 6mm, 7mm, 8mm, 9mm, 10mm, 11mm, 12mm, 13mm	Bits Set 2: 3/16, 7/32, 1/4, S1, S2, H3, H4, H5, H6
1/4" Drive Pear Ratchet Handle 72 Teeth 4.5"	Hex Adapter
1/4" Drive Extension Bar 2", 6"	Ratcheting Screwdriver
1/4" Drive Universal Joint	



Proffered[®] BBI TOOLS



The Quality You Know™

3/8" DRIVE STANDARD SOCKET MASTER SET-37 PIECE



Part No.	Description
S01002	PROFERRED 3/8" DRIVE STANDARD SAE-MT - 6 SOCKET MASTER SET 37 PIECE
3/8" Drive SAE 6 Point Standard Socket 1/4", 5/16", 3/8", 7/16", 1/2", 9/16", 5/8", 11/16", 3/4", 13/16", 7/8", 15/16", 1"	3/8" Drive Flex Handle (Breaker Bar) 10"
3/8" Drive Metric 6 Point Standard Socket 6mm, 7mm, 8mm, 9mm, 10mm, 11mm, 12mm, 13mm, 14mm, 15mm, 16mm, 17mm, 18mm, 19mm	Spark plug Sockets 5/8", 13/16"
3/8" Drive Pear Ratchet Handle 72 Teeth 8"	3/8" F - 1/4" M Adapter
3/8" Drive Extension Bar 3", 6", 10"	1/2" F - 3/8" M 3 way Adapter
3/8" Drive Universal Joint	

1/2" DRIVE STANDARD SOCKET MASTER SET-21 PIECE



Part No.	Description
S01003	PROFERRED 1/2" DRIVE STANDARD SAE - 12 POINT SOCKET MASTER SET 21 PIECE
1/2" Drive SAE 12 Point Standard Socket 3/8", 7/16", 1/2", 9/16", 5/8", 11/16", 3/4", 13/16", 7/8", 15/16", 1", 1-1/16", 1-1/8", 1-3/16", 1-1/4"	1/2" Drive Universal Joint
1/2" Drive Pear Ratchet Handle 60 Teeth 10"	1/2" Drive Flex Handle (Breaker Bar) 15"
1/2" Drive Extension Bar 5", 10"	3/8" F - 1/2" M 3 way Adapter

3/4" DRIVE STANDARD SOCKET MASTER SET-15 PIECE



Part No.	Description
S01004	PROFERRED 3/4" DRIVE STANDARD SAE - 12 POINT SOCKET MASTER SET 15 PIECE
3/4" Drive SAE 12 Point Standard Socket 7/8", 15/16", 1", 1-1/8", 1-1/4", 1-7/16", 1-1/2", 1-5/8", 1-3/4", 2"	3/4" Drive Universal Joint
3/4" Drive Pear Ratchet Handle 24 Teeth 20"	3/4" Drive Flex Handle (Breaker Bar) 20"
3/4" Drive Extension Bar 4", 8"	

1/4" DRIVE 6 POINT SOCKET SETS SAE-METRIC STANDARD & DEEP-11 PIECE SOCKET RAIL INCLUDED



Part No.	Description
S04001	PROFERRED 1/4" DRIVE SAE 6 POINT STANDARD SOCKET SET 11 PIECE
1/4" Drive SAE 6 Point Standard Socket 5/32", 3/16", 7/32", 1/4", 9/32", 5/16", 11/32", 3/8", 7/16", 1/2", 9/16"	
Part No.	Description
S04101	PROFERRED 1/4" DRIVE SAE 6 POINT DEEP SOCKET SET 11 PIECE
1/4" Drive SAE 6 Point Deep Socket 5/32", 3/16", 7/32", 1/4", 9/32", 5/16", 11/32", 3/8", 7/16", 1/2", 9/16"	

Part No.	Description
S05001	PROFERRED 1/4" DRIVE METRIC 6 POINT STANDARD SOCKET SET 11 PIECE
1/4" Drive Metric 6 Point Standard Socket 4mm, 5mm, 6mm, 7mm, 8mm, 9mm, 10mm, 11mm, 12mm, 13mm, 14mm	
Part No.	Description
S05101	PROFERRED 1/4" DRIVE METRIC 6 POINT DEEP SOCKET SET 11 PIECE
1/4" Drive Metric 6 Point Deep Socket 4mm, 5mm, 6mm, 7mm, 8mm, 9mm, 10mm, 11mm, 12mm, 13mm, 14mm	



Proffered® BBI TOOLS



The Quality You Know™

3/8" DRIVE SOCKET SETS 6 POINT & 12 POINT SAE-METRIC STANDARD & DEEP SOCKET RAIL INCLUDED

Part No.	Description
S06001	PROFERRED 3/8" DRIVE SAE 6 POINT STANDARD SOCKET SET 15 PIECE
3/8" Drive SAE 6 Point Standard Socket 1/4", 9/32", 5/16", 11/32", 3/8", 7/16", 1/2", 9/16", 5/8", 11/16", 3/4", 13/16", 7/8", 15/16", 1"	
S06301	PROFERRED 3/8" DRIVE SAE 12 POINT DEEP SOCKET SET 12 PIECE
3/8" Drive SAE 12 Point Deep Socket 1/4", 5/16", 11/32", 3/8", 7/16", 1/2", 9/16", 5/8", 11/16", 3/4", 13/16", 7/8"	

1/2" DRIVE 12 POINT SAE-METRIC SOCKET SETS STANDARD & DEEP SOCKET RAIL INCLUDED

Part No.	Description
S08201	PROFERRED 1/2" DRIVE SAE 12 POINT STANDARD SOCKET SET 15 PIECE
1/2" Drive SAE 12 Point Standard Socket 3/8", 7/16", 1/2", 9/16", 5/8", 11/16", 3/4", 13/16", 7/8", 15/16", 1", 1-1/16", 1-1/8", 1-3/16", 1-1/4"	
S08301	PROFERRED 1/2" DRIVE SAE 12 POINT DEEP SOCKET SET 12 PIECE
1/2" Drive SAE 12 Point Deep Socket 5/16", 3/8", 7/16", 1/2", 9/16", 5/8", 11/16", 3/4", 13/16", 7/8", 15/16", 1"	

1/2" DRIVE 6 POINT IMPACT SOCKET SETS

Part No.	Description
S11001	PROFERRED 1/2" DRIVE SAE 6 POINT STANDARD IMPACT SOCKET SET 15 PIECE
1/2" Drive SAE 6 Point Standard Impact Socket 3/8", 7/16", 1/2", 9/16", 5/8", 11/16", 3/4", 13/16", 7/8", 15/16", 1", 1-1/16", 1-1/8", 1-3/16", 1-1/4"	
S11101	PROFERRED 1/2" DRIVE SAE 6 POINT DEEP IMPACT SOCKET SET 15 PIECE
1/2" Drive SAE 6 Point Deep Impact Socket 3/8", 7/16", 1/2", 9/16", 5/8", 11/16", 3/4", 13/16", 7/8", 15/16", 1", 1-1/16", 1-1/8", 1-3/16", 1-1/4"	

CHROME & IMPACT SOCKETS

Features

- Stress reduced hex drive
- Forged for maximum strength
- Packed on a rail

Part No.	Description
1/4" DRIVE SAE 6 POINT STANDARD CHROME / DEEP CHROME SOCKETS	
S15005	Standard Chrome Socket 5/32"
S15006	Standard Chrome Socket 3/16"
S15007	Standard Chrome Socket 7/32"
S15008	Standard Chrome Socket 1/4"
S15009	Standard Chrome Socket 9/32"
S15010	Standard Chrome Socket 5/16"
S15011	Standard Chrome Socket 11/32"
S15012	Standard Chrome Socket 3/8"
S15014	Standard Chrome Socket 7/16"

Part No.	Description
S15016	Standard Chrome Socket 1/2"
S15018	Standard Chrome Socket 9/16"
S15105	Deep Chrome Socket 5/32"
S15106	Deep Chrome Socket 3/16"
S15107	Deep Chrome Socket 7/32"
S15108	Deep Chrome Socket 1/4"
S15109	Deep Chrome Socket 9/32"
S15110	Deep Chrome Socket 5/16"
S15111	Deep Chrome Socket 11/32"
S15112	Deep Chrome Socket 3/8"

Part No.	Description
S07001	PROFERRED 3/8" DRIVE METRIC 6 POINT STANDARD SOCKET SET 17 PIECE
3/8" Drive Metric 6 Point Standard Socket 6mm, 7mm, 8mm, 9mm, 10mm, 11mm, 12mm, 13mm, 14mm, 15mm, 16mm, 17mm, 18mm, 19mm, 21mm, 22mm, 24mm	
S07301	PROFERRED 3/8" DRIVE METRIC 12 POINT DEEP SOCKET SET 12 PIECE
3/8" Drive Metric 12 Point Deep Socket 8mm, 9mm, 10mm, 11mm, 12mm, 13mm, 14mm, 15mm, 16mm, 17mm, 18mm, 19mm	



Part No.	Description
S09201	PROFERRED 1/2" DRIVE METRIC 12 POINT STANDARD SOCKET SET 15 PIECE
1/2" Drive 12 Point Metric Standard Socket 10mm, 11mm, 12mm, 13mm, 14mm, 15mm, 17mm, 18mm, 19mm, 21mm, 22mm, 24mm, 27mm, 30mm, 32mm	
S09301	PROFERRED 1/2" DRIVE METRIC 12 POINT DEEP SOCKET SET 12 PIECE
1/2" Drive Metric 12 Point Deep Socket 10mm, 11mm, 12mm, 13mm, 14mm, 15mm, 17mm, 18mm, 19mm, 21mm, 22mm, 24mm	



Part No.	Description
S12001	PROFERRED 1/2" DRIVE METRIC 6 POINT STANDARD IMPACT SOCKET SET 16 PIECE
1/2" Drive Metric 6 Point Standard Impact Socket 10mm, 11mm, 12mm, 13mm, 14mm, 15mm, 17mm, 18mm, 19mm, 20mm, 21mm, 22mm, 24mm, 27mm, 30mm, 32mm	
S12101	PROFERRED 1/2" DRIVE METRIC 6 POINT DEEP IMPACT SOCKET SET 15 PIECE
1/2" Drive Metric 6 Point Deep Impact Socket 10mm, 11mm, 12mm, 13mm, 14mm, 15mm, 16mm, 17mm, 18mm, 19mm, 20mm, 21mm, 22mm, 24mm, 27mm	



Part No.	Description
S15114	Deep Chrome Socket 7/16"
S15116	Deep Chrome Socket 1/2"
S15118	Deep Chrome Socket 9/16"
1/4" DRIVE METRIC 6 POINT STANDARD CHROME / DEEP CHROME SOCKETS	
S16002	Standard Chrome Socket 4mm
S16003	Standard Chrome Socket 4.5mm
S16004	Standard Chrome Socket 5mm
S16005	Standard Chrome Socket 5.5mm
S16006	Standard Chrome Socket 6mm
S16007	Standard Chrome Socket 7mm

Part No.	Description
S16008	Standard Chrome Socket 8mm
S16009	Standard Chrome Socket 9mm
S16010	Standard Chrome Socket 10mm
S16011	Standard Chrome Socket 11mm
S16012	Standard Chrome Socket 12mm
S16013	Standard Chrome Socket 13mm
S16014	Standard Chrome Socket 14mm
S16102	Deep Chrome Socket 4mm
S16104	Deep Chrome Socket 5mm
S16106	Deep Chrome Socket 6mm



Proffered[®] BBI TOOLS

The Quality You Know™



Part No.	Description
S16107	Deep Chrome Socket 7mm
S16108	Deep Chrome Socket 8mm
S16109	Deep Chrome Socket 9mm
S16110	Deep Chrome Socket 10mm
S16111	Deep Chrome Socket 11mm
S16112	Deep Chrome Socket 12mm
S16113	Deep Chrome Socket 13mm
S16114	Deep Chrome Socket 14mm

3/8" DRIVE SAE 6 POINT STANDARD CHROME SOCKETS

S19008	Standard Chrome Socket 1/4"
S19010	Standard Chrome Socket 5/16"
S19012	Standard Chrome Socket 3/8"
S19014	Standard Chrome Socket 7/16"
S19016	Standard Chrome Socket 1/2"
S19018	Standard Chrome Socket 9/16"
S19020	Standard Chrome Socket 5/8"
S19022	Standard Chrome Socket 11/16"
S19024	Standard Chrome Socket 3/4"
S19026	Standard Chrome Socket 13/16"
S19028	Standard Chrome Socket 7/8"
S19030	Standard Chrome Socket 15/16"
S19032	Standard Chrome Socket 1"

3/8" DRIVE SAE 12 POINT DEEP CHROME SOCKETS

S19308	Deep Chrome Socket 1/4"
S19310	Deep Chrome Socket 5/16"
S19312	Deep Chrome Socket 3/8"
S19314	Deep Chrome Socket 7/16"
S19316	Deep Chrome Socket 1/2"
S19318	Deep Chrome Socket 9/16"
S19320	Deep Chrome Socket 5/8"
S19322	Deep Chrome Socket 11/16"
S19324	Deep Chrome Socket 3/4"
S19326	Deep Chrome Socket 13/16"
S19328	Deep Chrome Socket 7/8"
S19330	Deep Chrome Socket 15/16"
S19332	Deep Chrome Socket 1"

3/8" DRIVE METRIC 6 POINT STANDARD CHROME SOCKETS

S20006	Standard Chrome Socket 6mm
S20007	Standard Chrome Socket 7mm
S20008	Standard Chrome Socket 8mm
S20009	Standard Chrome Socket 9mm
S20010	Standard Chrome Socket 10mm
S20011	Standard Chrome Socket 11mm
S20012	Standard Chrome Socket 12mm
S20013	Standard Chrome Socket 13mm
S20014	Standard Chrome Socket 14mm
S20015	Standard Chrome Socket 15mm
S20016	Standard Chrome Socket 16mm
S20017	Standard Chrome Socket 17mm
S20018	Standard Chrome Socket 18mm
S20019	Standard Chrome Socket 19mm
S20021	Standard Chrome Socket 21mm
S20022	Standard Chrome Socket 22mm
S20024	Standard Chrome Socket 24mm

3/8" DRIVE METRIC 12 POINT DEEP CHROME SOCKETS

--	--

Part No.	Description
S20308	Deep Chrome Socket 8mm
S20309	Deep Chrome Socket 9mm
S20310	Deep Chrome Socket 10mm
S20311	Deep Chrome Socket 11mm
S20312	Deep Chrome Socket 12mm
S20313	Deep Chrome Socket 13mm
S20314	Deep Chrome Socket 14mm
S20315	Deep Chrome Socket 15mm
S20316	Deep Chrome Socket 16mm
S20317	Deep Chrome Socket 17mm
S20318	Deep Chrome Socket 18mm
S20319	Deep Chrome Socket 19mm

1/2" DRIVE SAE 12 POINT STANDARD CHROME / DEEP SOCKETS

S23212	Standard Chrome Socket 3/8"
S23214	Standard Chrome Socket 7/16"
S23216	Standard Chrome Socket 1/2"
S23218	Standard Chrome Socket 9/16"
S23220	Standard Chrome Socket 5/8"
S23222	Standard Chrome Socket 11/16"
S23224	Standard Chrome Socket 3/4"
S23226	Standard Chrome Socket 13/16"
S23228	Standard Chrome Socket 7/8"
S23230	Standard Chrome Socket 15/16"
S23232	Standard Chrome Socket 1"
S23234	Standard Chrome Socket 1-1/16"
S23236	Standard Chrome Socket 1-1/8"
S23238	Standard Chrome Socket 1-3/16"
S23240	Standard Chrome Socket 1-1/4"
S23310	Deep Chrome Socket 5/16"
S23312	Deep Chrome Socket 3/8"
S23314	Deep Chrome Socket 7/16"
S23316	Deep Chrome Socket 1/2"
S23318	Deep Chrome Socket 9/16"
S23320	Deep Chrome Socket 5/8"
S23322	Deep Chrome Socket 11/16"
S23324	Deep Chrome Socket 3/4"
S23326	Deep Chrome Socket 13/16"
S23328	Deep Chrome Socket 7/8"
S23330	Deep Chrome Socket 15/16"
S23332	Deep Chrome Socket 1"

1/2" DRIVE METRIC 12 POINT STANDARD CHROME / DEEP CHROME SOCKETS

S24210	Standard Chrome Socket 10mm
S24211	Standard Chrome Socket 11mm
S24212	Standard Chrome Socket 12mm
S24213	Standard Chrome Socket 13mm
S24214	Standard Chrome Socket 14mm
S24215	Standard Chrome Socket 15mm
S24216	Standard Chrome Socket 16mm
S24217	Standard Chrome Socket 17mm
S24218	Standard Chrome Socket 18mm
S24219	Standard Chrome Socket 19mm
S24221	Standard Chrome Socket 21mm
S24222	Standard Chrome Socket 22mm
S24223	Standard Chrome Socket 23mm
S24224	Standard Chrome Socket 24mm
S24226	Standard Chrome Socket 26mm

Part No.	Description
S24227	Standard Chrome Socket 27mm
S24230	Standard Chrome Socket 30mm
S24232	Standard Chrome Socket 32mm
S24310	Deep Chrome Socket 10mm
S24311	Deep Chrome Socket 11mm
S24312	Deep Chrome Socket 12mm
S24313	Deep Chrome Socket 13mm
S24314	Deep Chrome Socket 14mm
S24315	Deep Chrome Socket 15mm
S24317	Deep Chrome Socket 17mm
S24318	Deep Chrome Socket 18mm
S24319	Deep Chrome Socket 19mm
S24321	Deep Chrome Socket 21mm
S24322	Deep Chrome Socket 22mm
S24324	Deep Chrome Socket 24mm

3/8" DRIVE SAE 6 POINT IMPACT SOCKETS

S30010	Impact Socket 5/16"
S30012	Impact Socket 3/8"
S30014	Impact Socket 7/16"
S30016	Impact Socket 1/2"
S30018	Impact Socket 9/16"
S30020	Impact Socket 5/8"
S30022	Impact Socket 11/16"
S30024	Impact Socket 3/4"

3/8" DRIVE METRIC 6 POINT IMPACT SOCKETS

S31006	Impact Socket 6mm
S31008	Impact Socket 8mm
S31010	Impact Socket 10mm
S31011	Impact Socket 11mm
S31012	Impact Socket 12mm
S31013	Impact Socket 13mm
S31014	Impact Socket 14mm
S31015	Impact Socket 15mm
S31016	Impact Socket 16mm
S31017	Impact Socket 17mm
S31018	Impact Socket 18mm
S31019	Impact Socket 19mm

1/2" DRIVE SAE 6 POINT STANDARD / DEEP IMPACT SOCKETS

S32012	Impact Socket 3/8"
S32014	Impact Socket 7/16"
S32016	Impact Socket 1/2"
S32018	Impact Socket 9/16"
S32020	Impact Socket 5/8"
S32022	Impact Socket 11/16"
S32024	Impact Socket 3/4"
S32026	Impact Socket 13/16"
S32028	Impact Socket 7/8"
S32030	Impact Socket 15/16"
S32032	Impact Socket 1"
S32034	Impact Socket 1-1/16"
S32036	Impact Socket 1-1/8"
S32038	Impact Socket 1-3/16"
S32040	Impact Socket 1-1/4"
S32112	Deep Impact Socket 3/8"
S32114	Deep Impact Socket 7/16"
S32116	Deep Impact Socket 1/2"

Part No.	Description
S32118	Deep Impact Socket 9/16"
S32120	Deep Impact Socket 5/8"
S32122	Deep Impact Socket 11/16"
S32124	Deep Impact Socket 3/4"
S32126	Deep Impact Socket 13/16"
S32128	Deep Impact Socket 7/8"
S32130	Deep Impact Socket 15/16"
S32132	Deep Impact Socket 1"
S32134	Deep Impact Socket 1-1/16"
S32136	Deep Impact Socket 1-1/8"
S32138	Deep Impact Socket 1-3/16"
S32140	Deep Impact Socket 1-1/4"
S32142	Deep Impact Socket 1-5/16"
S32144	Deep Impact Socket 1-3/8"
S32146	Deep Impact Socket 1-7/16"
S32148	Deep Impact Socket 1-1/2"

1/2" DRIVE METRIC 6 POINT STANDARD / DEEP IMPACT SOCKETS

S33010	Impact Socket 10mm
S33011	Impact Socket 11mm
S33012	Impact Socket 12mm
S33013	Impact Socket 13mm
S33014	Impact Socket 14mm
S33015	Impact Socket 15mm
S33017	Impact Socket 17mm
S33018	Impact Socket 18mm
S33019	Impact Socket 19mm
S33020	Impact Socket 20mm
S33021	Impact Socket 21mm
S33022	Impact Socket 22mm
S33024	Impact Socket 24mm
S33027	Impact Socket 27mm
S33030	Impact Socket 30mm
S33032	Impact Socket 32mm
S33110	Deep Impact Socket 10mm
S33111	Deep Impact Socket 11mm
S33112	Deep Impact Socket 12mm
S33113	Deep Impact Socket 13mm
S33114	Deep Impact Socket 14mm
S33115	Deep Impact Socket 15mm
S33116	Deep Impact Socket 16mm
S33117	Deep Impact Socket 17mm
S33118	Deep Impact Socket 18mm
S33119	Deep Impact Socket 19mm
S33120	Deep Impact Socket 20mm
S33121	Deep Impact Socket 21mm
S33122	Deep Impact Socket 22mm
S33124	Deep Impact Socket 24mm
S33127	Deep Impact Socket 27mm
S33130	Deep Impact Socket 30mm
S33132	Deep Impact Socket 32mm
S33134	Deep Impact Socket 34mm
S33136	Deep Impact Socket 36mm

3/4" DRIVE SAE 6 POINT DEEP IMPACT SOCKETS

S34132	Deep Impact Socket 1"
S34134	Deep Impact Socket 1-1/16"
S34136	Deep Impact Socket 1-1/8"



Proffered® BBI TOOLS

The Quality You Know™



Part No.	Description
S34140	Deep Impact Socket 1-1/4"
S34142	Deep Impact Socket 1-5/16"
S34144	Deep Impact Socket 1-3/8"
S34146	Deep Impact Socket 1-7/16"

Part No.	Description
S34148	Deep Impact Socket 1-1/2"
3/4" DRIVE METRIC 6 POINT DEEP IMPACT SOCKETS	
S35126	Deep Impact Socket 26mm

Part No.	Description
S35127	Deep Impact Socket 27mm
S35130	Deep Impact Socket 30mm
S35132	Deep Impact Socket 32mm
S35133	Deep Impact Socket 33mm

Part No.	Description
S35135	Deep Impact Socket 35mm
S35136	Deep Impact Socket 36mm
S35138	Deep Impact Socket 38mm

1/4" DRIVE TINY BONE 5 IN 1 RATCHET HANDLE

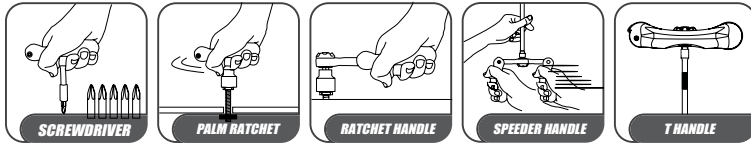

Part No.	Description
S39001	Proffered 1/4" Drive Tiny Bone 5 in 1 Ratchet Handle



SOCKET ACCESSORIES & RATCHETS



Part No.	Description
S40001	1/4" Drive Pear Ratchet Handle 72 Teeth 4.5"
S43001	1/4" Drive Extension Bar 2"
S43002	1/4" Drive Extension Bar 4"
S43003	1/4" Drive Extension Bar 6"
S45001	1/4" Drive Universal Joint
S49001	1/4" Drive Magnetic Aluminum Socket Rail 12" Length with 15 Clips
S40101	3/8" Drive Pear Ratchet Handle 72 Teeth 8"
S41101	3/8" Drive Flex Handle (Breaker Bar) 10"
S42101	3/8" Drive Cobra Flex Handle (Breaker Bar) 8"
S43101	3/8" Drive Extension Bar 3"
S43102	3/8" Drive Extension Bar 6"
S43103	3/8" Drive Extension Bar 10"
S44101	3/8" Drive Impact Extension Bar 3"
S44102	3/8" Drive Impact Extension Bar 6"
S45101	3/8" Drive Universal Joint
S46101	3/8" Impact Universal Joint

Part No.	Description
S47101	3/8" F - 1/4" M Adapter
S47102	3/8" F - 1/2" M Adapter
S49101	3/8" Drive Magnetic Aluminum Socket Rail 17" Length with 15 Clips
S40201	1/2" Drive Pear Ratchet Handle 60 Teeth 10"
S41201	1/2" Drive Flex Handle (Breaker Bar) 15"
S42201	1/2" Drive Cobra Flex Handle (Breaker Bar) 10"
S43201	1/2" Drive Extension Bar 5"
S43202	1/2" Drive Extension Bar 10"
S43203	1/2" Drive Extension Bar 20"
S44201	1/2" Drive Impact Extension Bar 5"
S44202	1/2" Drive Impact Extension Bar 10"
S45201	1/2" Drive Universal Joint
S46201	1/2" Impact Universal Joint
S47201	1/2" F - 3/8" M Adapter
S47202	1/2" F - 3/4" M Adapter
S49201	1/2" Drive Magnetic Aluminum Socket Rail 19" Length with 15 Clips



STEEL STAPLE GUN TACKER / HAMMER TACKER

Features

- Bottom loading magazine.
- Durable all-steel construction.
- Ergonomic handle grip.



Part No.	Description
T40001	Proffered Steel Staple Gun Tacker
T41001	Proffered Hammer Tacker
T42001	Proffered Staples 1/4" (6mm) Height, 1.2mm Thick, 10.6mm Wide
T42002	Proffered Staples 5/16" (8mm) Height, 1.2mm Thick, 10.6mm Wide

Part No.	Description
T42003	Proffered Staples 3/8" (10mm) Height, 1.2mm Thick, 10.6mm Wide
T42004	Proffered Staples 1/2" (12mm) Height, 1.2mm Thick, 10.6mm Wide
T42005	Proffered Staples 9/16" (14mm) Height, 1.2mm Thick, 10.6mm Wide

25' TAPE MEASURE 1" BLADE

Features

- Durable nylon coated steel blade with double hook secured on both sides of the blade.
- ABS case designed with ergonomic TPR grip to fit comfortably in your hand.
- Safety buffer absorbs backlash during tape retraction.



Part No.	Description
T53001	Proffered 25' Tape Measure 1" Blade

25'/8M TAPE MEASURES NEW

Features

- Tape Hook (end tip) made of stainless steel-more durable.
- Inch on top-1/8" increments on bottom.
- 16" marks in bold & blocked for framing studs.
- Black diamond placed for drywall installers to locate stud centers.
- Hi-impact ABS housing with non slip TPR grip.
- Nylon coated blade with magnetic tip.
- Dual side printed.
- Metric on top and bottom.



Part No.	Description
T53002	Proffered 25' Tape Measure 1 1/16" Blade

Part No.	Description
T53102	Proffered 8m Tape Measure 27mm Blade

RETRACTABLE UTILITY KNIFE / 12 PIECES UTILITY BLADES

Features

- Blade change: quick release for easy exchange of blades.
- Pop up blade dispenser release button allows instant blade change. No tools required.
- SK2 blades: 5 additional high carbon SK2 blades inside the pop up blade dispenser.
- Thermoplastic rubber (TPR) soft grip offers thumb rest and comfortable use with less slippage.



T55001

Part No.	Description
T54001	Proffered Retractable Utility Knife

Part No.	Description
T55001	Proffered 12 Pieces Utility Blades



HEAVY DUTY ADJUSTABLE WRENCH INDUSTRIAL BLACK PHOSPHATE

LENGTH: 6", 8", 10", 12", 15", 18", 24"

Features

- Raised head design prevents unintended change to the opening width of jaw while wrench is laid flat. Available in 6"-15".
- 15 degree offset allows for ease of use in tight working areas.
- Thin jaw improves access in tight spaces.
- Wider grip opening design allows for wider range of fastener sizes.

Part No.	Description
T05042	Proffered 6" Heavy Duty Adjustable Wrench Industrial Black Phosphate
T05043	Proffered 8" Heavy Duty Adjustable Wrench Industrial Black Phosphate
T05044	Proffered 10" Heavy Duty Adjustable Wrench Industrial Black Phosphate
T05045	Proffered 12" Heavy Duty Adjustable Wrench Industrial Black Phosphate



Part No.	Description
T05046	Proffered 15" Heavy Duty Adjustable Wrench Industrial Black Phosphate
T05007	Proffered 18" Heavy Duty Adjustable Wrench Industrial Black Phosphate
T05009	Proffered 24" Heavy Duty Adjustable Wrench Industrial Black Phosphate

HEAVY DUTY ADJUSTABLE WRENCH CHROME FINISH

LENGTH: 4", 6", 8", 10", 12", 15", 18", 24"

Features

- Raised head design prevents unintended change to the opening width of jaw while wrench is laid flat. Available in 6"-15".
- 15 degree offset allows for ease of use in tight working areas.
- Thin jaw improves access in tight spaces.
- Wider grip opening design allows for wider range of fastener sizes.

Part No.	Description
T05011	Proffered 4" Heavy Duty Adjustable Wrench Chrome Finish
T05052	Proffered 6" Heavy Duty Adjustable Wrench Chrome Finish
T05053	Proffered 8" Heavy Duty Adjustable Wrench Chrome Finish
T05054	Proffered 10" Heavy Duty Adjustable Wrench Chrome Finish



Part No.	Description
T05055	Proffered 12" Heavy Duty Adjustable Wrench Chrome Finish
T05056	Proffered 15" Heavy Duty Adjustable Wrench Chrome Finish
T05017	Proffered 18" Heavy Duty Adjustable Wrench Chrome Finish
T05019	Proffered 24" Heavy Duty Adjustable Wrench Chrome Finish

MINING ADJUSTABLE WRENCH WITH HAMMER

LENGTH: 12"

Features

- 5 tools in 1: adjustable wrench, pipe wrench, hammer, 7/8" ratcheting box end, 1/2" drive ratcheting wrench
- Rust resistant SAE 6140 Steel.
- Fully heat treated, hot forged handle.
- Ergonomically designed for a comfortable hand grip.
- Wrench comes with a dual hide holster belt clip with chain for additional tool attachments.

Part No.	Description
T10001	Proffered 12" Mining Adjustable Wrench w/ Hammer





PLUMBING ADJUSTABLE WRENCH

LENGTH: 6", 8", 10", 12"

Features

- Ideal for plumbing, automotive and gas industries.
- Super thin head allows for use in limited and narrow spaces.
- Greater jaw capacity allows 55% wider opening than traditional wrench.
- Jaw depth is 30% higher than general wrench.

Part No.	Description
T08001	Proffered 6" Plumbing Adjustable Wrench
T08002	Proffered 8" Plumbing Adjustable Wrench



Part No.	Description
T08003	Proffered 10" Plumbing Adjustable Wrench
T08004	Proffered 12" Plumbing Adjustable Wrench

QUICK SNAP ADJUSTABLE WRENCH

LENGTH: 8"

Features

- Greater jaw capacity
- Quick release jaw allows for fast setting with one easy pull.
- Dual teeth fits SAE and Metric fastener specifications.
- Micro-adjusting the movable pad allows the knurl to adjust the jaw opening. Convenient and 5-times faster operation.

Part No.	Description
T07001	Proffered 8" Quick Snap Adjustable Wrench



RATCHETING ADJUSTABLE WRENCH

LENGTH: 8"

Features

- Combination function ratcheting and adjusting.
- Efficient ratcheting function offers greater efficiency compared to conventional wrenches.
- Anti-slip comfort grip design TPR material handle with ridged design ensures a strong grip and prevents slippage.

Part No.	Description
T09002	Proffered 8" Ratcheting Adjustable Wrench



TIGER'S PAW™ ADJUSTABLE WRENCH WITH PADDED HANDLE

LENGTH: 6", 8", 10", 12"

Features

- Head triangle increased hardness - HRC 3 degrees.
- The hole design reduces overall weight by 10%, eliminating physical stress.
- Jaw teeth protects the corners of the nuts, while reducing slippage at the same time.
- Anti-slip TPR material ensures a comfortable grip.

Part No.	Description
T06002	Proffered 6" Tiger's Paw™ Adjustable Wrench w/ Padded Handle
T06003	Proffered 8" Tiger's Paw™ Adjustable Wrench w/ Padded Handle



Part No.	Description
T06004	Proffered 10" Tiger's Paw™ Adjustable Wrench w/ Padded Handle
T06005	Proffered 12" Tiger's Paw™ Adjustable Wrench w/ Padded Handle



Proffered® BBI TOOLS



The Quality You Know™

COMBINATION WRENCHES

Features

- Precision: manufactured to ANSI & DIN industrial standards.
- Durability: quality chrome vanadium steel. Precision heat treated and drop forged for maximum strength.
- Visibility: larger marking for easy size identification.



T45001



T45002



T45003

Part No.	Description
T45001	Proffered 9 Pieces Combination Wrenches Set (1/4" - 3/4")
T45002	Proffered 14 Pieces Combination Wrenches Set (3/8" - 1 1/4")
T45003	Proffered 4 Pieces Combination Wrenches Set (1 5/16", 1 3/8", 1 7/16", 1 1/2")
T46005	Proffered 1/4" Combination Wrench, 12 Pt.
T46007	Proffered 5/16" Combination Wrench, 12 Pt.
T46009	Proffered 3/8" Combination Wrench, 12 Pt.
T46010	Proffered 7/16" Combination Wrench, 12 Pt.
T46011	Proffered 1/2" Combination Wrench, 12 Pt.
T46012	Proffered 9/16" Combination Wrench, 12 Pt.
T46013	Proffered 5/8" Combination Wrench, 12 Pt.
T46014	Proffered 11/16" Combination Wrench, 12 Pt.
T46015	Proffered 3/4" Combination Wrench, 12 Pt.

Part No.	Description
T46016	Proffered 13/16" Combination Wrench, 12 Pt.
T46017	Proffered 7/8" Combination Wrench, 12 Pt.
T46018	Proffered 15/16" Combination Wrench, 12 Pt.
T46019	Proffered 1" Combination Wrench, 12 Pt.
T46020	Proffered 1-1/16" Combination Wrench, 12 Pt.
T46021	Proffered 1-1/8" Combination Wrench, 12 Pt.
T46023	Proffered 1-1/4" Combination Wrench, 12 Pt.
T46024	Proffered 1-5/16" Combination Wrench, 12 Pt.
T46025	Proffered 1-3/8" Combination Wrench, 12 Pt.
T46026	Proffered 1-7/16" Combination Wrench, 12 Pt.
T46027	Proffered 1-1/2" Combination Wrench, 12 Pt.

14 PIECE 12 POINT COMBINATION WRENCH SET METRIC 8MM-22MM

NEW

Features

- Drop Forged and precision heat treated for maximum strength.
- Manufactured to ANSI & DIN industrial standards.
- High visibility with larger marking for easy size identification.
- Open stock wrenches.



Part No.	Description
T45102	PROFFERED 14 PIECE 12 POINTS PROFFERED COMBINATION WRENCH SET METRIC

Part No.	Description	Part No.	Description
T46108	Proffered 8mm 12 Points Combination Wrench, Chrome Finish	T46116	Proffered 16mm 12 Points Combination Wrench, Chrome Finish
T46110	Proffered 10mm 12 Points Combination Wrench, Chrome Finish	T46117	Proffered 17mm 12 Points Combination Wrench, Chrome Finish
T46111	Proffered 11mm 12 Points Combination Wrench, Chrome Finish	T46118	Proffered 18mm 12 Points Combination Wrench, Chrome Finish
T46112	Proffered 12mm 12 Points Combination Wrench, Chrome Finish	T46119	Proffered 19mm 12 Points Combination Wrench, Chrome Finish
T46113	Proffered 13mm 12 Points Combination Wrench, Chrome Finish	T46120	Proffered 20mm 12 Points Combination Wrench, Chrome Finish
T46114	Proffered 14mm 12 Points Combination Wrench, Chrome Finish	T46121	Proffered 21mm 12 Points Combination Wrench, Chrome Finish
T46115	Proffered 15mm 12 Points Combination Wrench, Chrome Finish	T46122	Proffered 22mm 12 Points Combination Wrench, Chrome Finish



Proffered[®] BBI TOOLS



The Quality You Know™

PIPE WRENCH

NEW

Features

- Forged steel.
- Long weighted handle for stability and leverage.
- 14" can take a 2" diameter pipe.
- 18" can take a 2-1/2" diameter pipe.



Part No.	Description
T11014	Proffered Pipe Wrench 14"

Part No.	Description
T11018	Proffered Pipe Wrench 18"

FLEX RATCHETING WRENCH

SIZE: 1/4", 5/16", 3/8", 7/16", 1/2", 9/16", 5/8", 11/16", 3/4"

Features

- Torque capability is 30% greater than ANSI industrial standard.
- 72 teeth ratcheting box end needs only 5 degrees swing arc versus 30 degrees for standard box end wrenches.
- Durability quality chrome vanadium steel. Precision heat treated for maximum strength.
- Flex head tilts up to 180 degrees.



Part No.	Description
T44008	Proffered 1/4" Flex Ratcheting Wrench
T44010	Proffered 5/16" Flex Ratcheting Wrench
T44012	Proffered 3/8" Flex Ratcheting Wrench
T44014	Proffered 7/16" Flex Ratcheting Wrench
T44016	Proffered 1/2" Flex Ratcheting Wrench

Part No.	Description
T44018	Proffered 9/16" Flex Ratcheting Wrench
T44020	Proffered 5/8" Flex Ratcheting Wrench
T44022	Proffered 11/16" Flex Ratcheting Wrench
T44024	Proffered 3/4" Flex Ratcheting Wrench

HAND & TOOL WIPES CANISTER / SINGLE PACK

Features

- Dual cleaning surfaces textured and non-scratching cleaning surface.
- Lint free sturdy wipes scrub without tearing.
- No VOCs safe for the environment.
- 82 9"x12" wipes in each canister.
- No water needed
- Cuts grease, grime, oil dirt, lube and mastic but safe on hands.



Part No.	Description
T99001	Proffered Hand & Tool Wipes Canister

Part No.	Description
T99003	Proffered Hand & Tool Wipes Single Pack

HIGH SPEED DRILL BIT SET

Features

- 21-piece Jobber Length Set
- 1/16" - 3/8" in 1/64" increments
- M2 material with a black finish
- Split drill point
- 135° cutting angle
- Brinell hardness HB 200-220
- Plastic storage index case

Part No.	Description
C20001	Proffered High Speed Steel Twist Drill Bit Set





Proffered® BBI TOOLS



The Quality You Know™

29 PIECE HIGH SPEED STEEL TWIST DRILL BIT SET NEW

Features

- M35 Cobalt Steel.
- Cuts Faster, Lasts Longer, Increased Heat Resistance vs. M2 Carbon Bits.
- Full Range Bit Assortment.



Part No.	Description	Part No.	Description
C20002	PROFERRED 29 PIECE HIGH SPEED STEEL TWIST DRILL BIT SET		
C22004	Proffered M35 High Speed Steel Twist Drill Bit 1/16"	C22019	Proffered M35 High Speed Steel Twist Drill Bit 19/64"
C22005	Proffered M35 High Speed Steel Twist Drill Bit 5/64"	C22020	Proffered M35 High Speed Steel Twist Drill Bit 5/16"
C22006	Proffered M35 High Speed Steel Twist Drill Bit 3/32"	C22021	Proffered M35 High Speed Steel Twist Drill Bit 21/64"
C22007	Proffered M35 High Speed Steel Twist Drill Bit 7/64"	C22022	Proffered M35 High Speed Steel Twist Drill Bit 11/32"
C22008	Proffered M35 High Speed Steel Twist Drill Bit 1/8"	C22023	Proffered M35 High Speed Steel Twist Drill Bit 23/64"
C22009	Proffered M35 High Speed Steel Twist Drill Bit 9/64"	C22024	Proffered M35 High Speed Steel Twist Drill Bit 3/8"
C22010	Proffered M35 High Speed Steel Twist Drill Bit 5/32"	C22025	Proffered M35 High Speed Steel Twist Drill Bit 25/64"
C22011	Proffered M35 High Speed Steel Twist Drill Bit 11/64"	C22026	Proffered M35 High Speed Steel Twist Drill Bit 13/32"
C22012	Proffered M35 High Speed Steel Twist Drill Bit 3/16"	C22027	Proffered M35 High Speed Steel Twist Drill Bit 27/64"
C22013	Proffered M35 High Speed Steel Twist Drill Bit 13/64"	C22028	Proffered M35 High Speed Steel Twist Drill Bit 7/16"
C22014	Proffered M35 High Speed Steel Twist Drill Bit 7/32"	C22029	Proffered M35 High Speed Steel Twist Drill Bit 29/64"
C22015	Proffered M35 High Speed Steel Twist Drill Bit 15/64"	C22030	Proffered M35 High Speed Steel Twist Drill Bit 15/32"
C22016	Proffered M35 High Speed Steel Twist Drill Bit 1/4"	C22031	Proffered M35 High Speed Steel Twist Drill Bit 31/64"
C22017	Proffered M35 High Speed Steel Twist Drill Bit 17/64"	C22032	Proffered M35 High Speed Steel Twist Drill Bit 1/2"
C22018	Proffered M35 High Speed Steel Twist Drill Bit 9/32"		

HACKSAW FRAME NEW

Features

- Professional hacksaw frame.
- Fully adjustable tension mechanism.
- Holds blade up to 37,500 PSI.
- Single thumb-dial adjustable tension mechanism for easy adjustment.
- Pro-quick release lever allows for fast blade change.
- Ergonomic handle designed with front thumb soft grip to give better control.
- 45 and 90 degree cuttg angles.

Part No.	Description
T56002	Proffered Hacksaw Frame 12"



HACKSAW BLADE NEW

Features

- 24T bi-metal steel blade.
- Cuts material 3.2mm-6.4mm, 1/8"-1/4".
- Suitable for conduit, heavy sheet metal.

Part No.	Description
T57004	Proffered 24T HSS Bi-Metal Hacksaw Blade

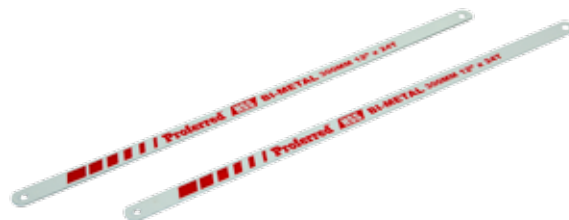



DISPOSABLE POWDER FREE NITRILE GLOVE NEW

Features

- Protection from unwanted and dangerous substances.
- Beaded cuff ensures easy on and off and prevent roll down.
- Superior strength with better puncture resistance 5 Mil.
- Textured surface enhances wet and dry gripping.
- Provides an alternative solution for individuals who are allergic to natural rubber latex.
- Applicable to automotive, safety, sanitary, medical, tattoo, lab, manufacturing industries and more.
- Enhanced safety with a striking and visible ORANGE color.

Part No.	Description
M01002	Proffered Disposable Powder Free Nitrile Glove M (Blue 5 Mil)
M01003	Proffered Disposable Powder Free Nitrile Glove L (Blue 5 Mil)
M01004	Proffered Disposable Powder Free Nitrile Glove XL (Blue 5 Mil)
M01007	Proffered Disposable Powder Free Nitrile Glove M (Black 5 Mil)
M01008	Proffered Disposable Powder Free Nitrile Glove L (Black 5 Mil)



Part No.	Description
M01009	Proffered Disposable Powder Free Nitrile Glove XL (Black 5 Mil)
M01012	Proffered Disposable Powder Free Nitrile Glove M (Orange 5 Mil)
M01013	Proffered Disposable Powder Free Nitrile Glove L (Orange 5 Mil)
M01014	Proffered Disposable Powder Free Nitrile Glove XL (Orange 5 Mil)

INDUSTRIAL GLOVE KIT-DISPLAY (36 PAIRS) NEW

Features

- Pre-assembled floor glove display.
- Includes: M05103, M05104, M05108, M05109, M05113, M05114, M05118, M05119, M05123, M05124, M05128.

Part No.	Description
M04001	Proffered Industrial Glove Kit-Display (36 Pairs)



POLYURETHANE COATED INDUSTRIAL GLOVES NEW

Features

- Black 15 gauge nylon knit, dipped with black polyurethane.
- Touch screen technology gives the user excellent control over any touch screen device.
- Superior dry, wet, and oily grip.
- Superior dexterity and touch sensitivity.
- Abrasion Level 3 - ANSI 105:2011.

Part No.	Description
M05102	Proffered Polyurethane Coated Industrial Gloves, Touch Screen, ANSI Abrasion 3 (M)
M05103	Proffered Polyurethane Coated Industrial Gloves, Touch Screen, ANSI Abrasion 3 (L)



Part No.	Description
M05104	Proffered Polyurethane Coated Industrial Gloves, Touch Screen, ANSI Abrasion 3 (XL)

CUT RESISTANT INDUSTRIAL GLOVES NEW

Features

- Cut color coded level 3 cut protection - ANSI 105:2011.
- Touch screen technology gives the user excellent control over any touch screen device.
- Superior dry, wet, and oily grip.
- Unrivaled Comfort - 13 gauge, HPPE liner for comfort.
- Abrasion Level 6 - ANSI 105:2011.

Part No.	Description
M06003	Proffered Level 3 Cut Resistant Industrial Gloves, Touch Screen, ANSI Abrasion 6 (L)



Part No.	Description
M06004	Proffered Level 3 Cut Resistant Industrial Gloves, Touch Screen, ANSI Abrasion 6 (XL)

TRIPLE POLYMER COATED INDUSTRIAL GLOVES NEW

Features

- Red 15 gauge nylon/lycra palm coated with triple polymer hybrid blend providing the highest level in performance properties.
- Touch screen technology gives the user excellent control over any touch screen device.
- Superior dry, wet, and oily grip.
- Abrasion Level 6 - ANSI 105:2011 gives long lasting protection and wear.

Part No.	Description
M05107	Proffered Hybrid Triple Polymer Coated Industrial Gloves, Touch Screen, ANSI Abrasion 6 (M)
M05108	Proffered Hybrid Triple Polymer Coated Industrial Gloves, Touch Screen, ANSI Abrasion 6 (L)



Part No.	Description
M05109	Proffered Hybrid Triple Polymer Coated Industrial Gloves, Touch Screen, ANSI Abrasion 6 (XL)



Proffered® BBI TOOLS



The Quality You Know™

MECHANICS INDUSTRIAL GLOVES **NEW**

Features

- Red 15 guage nylon/lycra palm coated with triple polymer hybrid blend providing the highest level in performance properties.
- Touch screen technology gives the user excellent control over any touch screen device.
- Superior dry, wet, and oily grip.
- Abrasion Level 6 - ANSI 105:2011 gives long lasting protection and wear.

Part No.	Description
M05112	Proffered Mechanics Industrial Gloves, Touch Screen (M)
M05113	Proffered Mechanics Industrial Gloves, Touch Screen (L)



Part No.	Description
M05114	Proffered Mechanics Industrial Gloves, Touch Screen (XL)

PIGSKIN INDUSTRIAL GLOVES **NEW**

Features

- 100% grain Leather.
- Keystone Thumb-Reinforced for comfort.
- Shirred elastic wrist.
- Ideal for outdoor use.

Part No.	Description
M05117	Proffered Pigskin Industrial Gloves (M)
M05118	Proffered Pigskin Industrial Gloves (L)



Part No.	Description
M05119	Proffered Pigskin Industrial Gloves (XL)

COWHIDE INDUSTRIAL GLOVES **NEW**

Features

- Suede cowhide palm. Fiber dense suede cowhide is strong and comfortable.
- Cotton denim back. Denim is comfortable and durable improving with age and wear.
- Rubberized safety cuff. Puncture resistant cuff falls past the wrist for optimum protection.
- Size large.
- Rubberized safety cuff.
- Cowhide leather palm.
- Cotton denim back.

Part No.	Description
M05123	Proffered Cowhide Industrial Gloves (L)



Part No.	Description
M05124	Proffered Cowhide Industrial Gloves (XL)

KNITTED INDUSTRIAL GLOVES WITH PVC DOTS **NEW**

Features

- Two sided PVC dotted, cotton string knit working gloves.
- These white String Knit Cotton Poly Gloves, with Dotted Black Rubber on both sides, are very popular and widely used. These gloves help protect the hands from sharp edges of metal, ceramics, glass and other materials. The dots on both sides provide firm sure grip, and don't let what you're working on slip out of your hands.
- The gloves are a little stretchy for comfortable, easy on and off. Full Finger Knitted Ribbing Protects the fingers; palm, hand back, and wrist from possible hurts in some working situations. Used in Automotive, Warehouse, Sanitation, Movers, construction, plumbing, masonry, material handling, lawn/garden, Farming, and Painting.

Part No.	Description
M05128	Proffered Knitted Industrial Gloves with PVC Dots (L)



BROWN JERSEY GLOVES **NEW**

Features

- Single palm 8 oz. brown jersey knit.
- Knit wrist for comfort.
- Outdoor general purpose work-farming, cleaning ,digging, paving, machinery operation, mowing and maintenance.

Part No.	Description
M05130	Proffered brown jersey gloves (L)





NYLON 6.6 WHITE CABLE TIES

NEW

Features

- Self locking ties.
- Available in 5 lengths all 50lb rated.
- Made from high strength & light weight nylon.
- Working temperature -40 to 185 F.

Part No.	Description
M10006	Proffered Nylon 6.6 Natural White Cable Ties 4" (18lb)
M10015	Proffered Nylon 6.6 Natural White Cable Ties 6" (40lb)
M10017	Proffered Nylon 6.6 Natural White Cable Ties 6.25" (50lb)
M10026	Proffered Nylon 6.6 Natural White Cable Ties 8" (50lb)

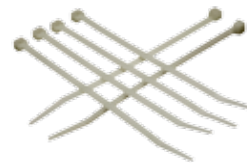

Part No.	Description
M10034	Proffered Nylon 6.6 Natural White Cable Ties 10" (50lb)
M10044	Proffered Nylon 6.6 Natural White Cable Ties 11" (50lb)
M10045	Proffered Nylon 6.6 Natural White Cable Ties 12" (50lb)
M10050	Proffered Nylon 6.6 Natural White Cable Ties 14.5" (50lb)

NYLON 6.6 UV RATED BLACK CABLE TIES

NEW

Features

- Self locking ties.
- Available in 5 lengths all 50lb rated.
- UL listed 6.6 nylon-Approved for outdoor use.
- Working temperature -40 to 185 F.

Part No.	Description
M11106	Proffered Nylon 6.6 Black UV Rated Cable Ties 4" (18lb)
M11115	Proffered Nylon 6.6 Black UV Rated Cable Ties 6" (40lb)
M11117	Proffered Nylon 6.6 Black UV Rated Cable Ties 6.25" (50lb)
M11126	Proffered Nylon 6.6 Black UV Rated Cable Ties 8" (50lb)
M11134	Proffered Nylon 6.6 Black UV Rated Cable Ties 10" (50lb)

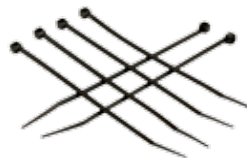

Part No.	Description
M11144	Proffered Nylon 6.6 Black UV Rated Cable Ties 11" (50lb)
M11145	Proffered Nylon 6.6 Black UV Rated Cable Ties 12" (50lb)
M11150	Proffered Nylon 6.6 Black UV Rated Cable Ties 14.5" (50lb)
M11152	Proffered Nylon 6.6 Black UV Rated Cable Ties 14.5" (120lb)

CLEAR SAFETY GLASSES WITH ANTI-UVA & UVB & ENFOG ANSI Z87.1 COMPLIANT

NEW

Features

- Anti-UVA & UVB & ENFOG clear lenses.

Part No.	Description
M15030	Veratti GT Anti-UVA & UVB & ENFOG Clear Lenses



GRAY SAFETY GLASSES WITH ANTI-UVA & UVB & ENFOG ANSI Z87.1 COMPLIANT

NEW

Features

- Anti-UVA & UVB & ENFOG gray lenses.

Part No.	Description
M15031	Veratti GT Anti-UVA & UVB & ENFOG Gray Lenses



YELLOW SAFETY GLASSES WITH ANTI-UVA & UVB & SCRATCHCOAT ANSI Z87.1 COMPLIANT

NEW

Features

- Anti-UVA & UVB & Scratchcoat yellow lenses.

Part No.	Description
M15032	Veratti GT Anti-UVA & UVB & Scratchcoat Yellow Lenses





CLEAR BIFOCALS SAFETY GLASSES WITH ANTI-UVA & UVB & SCRATCHCOAT ANSI Z87.1 COMPLIANT

NEW

Features

- Bifocals in +1.5, +2.0 & +2.5 strength.
- Anti-UVA & UVB & Scratchcoat clear lenses.

Part No.	Description
M15041	Veratti GT Bifocals +1.5 Anti-UVA & UVB & Scratchcoat Clear Lenses
M15042	Veratti GT Bifocals +2.0 Anti-UVA & UVB & Scratchcoat Clear Lenses



Part No.	Description
M15043	Veratti GT Bifocals +2.5 Anti-UVA & UVB & Scratchcoat Clear Lenses

CLEAR SAFETY GLASSES WITH ANTI-UVA & UVB & ENFOG ANSI Z87.1 COMPLIANT

NEW

Features

- Anti-UVA & UVB & ENFOG clear lenses.

Part No.	Description
M15050	Veratti 429 Anti-UVA & UVB & ENFOG Clear Lenses



GRAY SAFETY GLASSES WITH ANTI-UVA & UVB & ENFOG ANSI Z87.1 COMPLIANT

NEW

Features

- Anti-UVA & UVB & ENFOG gray lenses.

Part No.	Description
M15051	Veratti 429 Anti-UVA & UVB & ENFOG Gray Lenses



MINI CLEAR SAFETY GLASSES WITH ANTI-UVA & UVB & ENFOG ANSI Z87.1 COMPLIANT

NEW

Features

- Mini anti-UVA & UVB & ENFOG clear lenses.

Part No.	Description
M15060	Mini Anti-UVA & UVB & ENFOG Clear Lenses



YELLOW ANSI CLASS 2 BREAKAWAY REFLECTIVE VEST

NEW

Features

- ANSI Class 2 reflective vest - yellow.
- 5 point breakaway vest - 2 pockets - 4 sizes.

Part No.	Description
M18010	Proffered Yellow ANSI Class 2 Breakaway Reflective Vest (M)
M18011	Proffered Yellow ANSI Class 2 Breakaway Reflective Vest (L)



Part No.	Description
M18012	Proffered Yellow ANSI Class 2 Breakaway Reflective Vest (XL)
M18013	Proffered Yellow ANSI Class 2 Breakaway Reflective Vest (XXL)

ORANGE ANSI CLASS 2 BREAKAWAY REFLECTIVE VEST

NEW

Features

- ANSI Class 2 reflective vest - orange.
- 5 point breakaway vest - 2 pockets - 4 sizes.

Part No.	Description
M18020	Proffered Orange ANSI Class 2 Breakaway Reflective Vest (M)
M18021	Proffered Orange ANSI Class 2 Breakaway Reflective Vest (L)



Part No.	Description
M18022	Proffered Orange ANSI Class 2 Breakaway Reflective Vest (XL)
M18023	Proffered Orange ANSI Class 2 Breakaway Reflective Vest (XXL)



Proffered®

BBI TOOLS

U.S.A.

Atlanta, GA

250 Horizon Dr.
Suwanee, GA 30024
Tel. 678-459-3700
Fax: 678-459-3720
WATS: 800-275-0056
atlanta@brightonbest.com

Boston, MA

928 West Chestnut St.
Brockton MA 02301
Tel. 508-857-2808
Fax: 774-296-8685
WATS: 800-275-0037
boston@brightonbest.com

Charlotte, NC

2801-J Hutchison McDonald Rd. Ste. H
Charlotte, NC 28269
Tel. 704-597-5977
Fax: 704-597-1599
WATS: 800-275-0050
charlotte@brightonbest.com

Chicago, IL

940 North Enterprise St.
Aurora, IL 60504
Tel. 630-898-9600
Fax: 630-898-9601
WATS: 800-929-2378
chicago@brightonbest.com

Cleveland, OH

16065 Imperial Pkwy.
Strongsville, OH 44149
Tel. 440-238-1350
Fax: 440-238-2336
WATS: 800-275-0048
cleveland@brightonbest.com

Dallas, TX

3225 Roy Orr Blvd., Ste. 200
Grand Prairie, TX 75050
Tel. 972-790-1201
Fax: 972-790-6265
WATS: 800-275-0054
dallas@brightonbest.com

Denver, CO

9700 E. 56th Ave., Unit 120
Denver, CO 80238
Tel. 303-576-0530
Fax: 303-371-9775
WATS: 800-935-2202
denver@brightonbest.com

Detroit, MI

51251 Fogg Industrial Ct.
Shelby Township, MI 48315
Tel. 586-412-3350
Fax: 586-412-3305
WATS: 800-275-0046
detroit@brightonbest.com

Houston, TX

6911 Fairbanks N. Houston Rd. Ste. 150
Houston, TX 77040
Tel: 713-466-0336
Fax: 713-466-0385
WATS: 800-275-0054
houston@brightonbest.com

Logan Township, NJ

2100 Center Square Rd. Ste. 100
Logan Township, NJ 08085
Tel. 856-241-9494
Fax: 856-241-9477
WATS: 800-935-2378
logan@brightonbest.com

Los Angeles, CA

12801 Leffingwell Ave.
Santa Fe Springs, CA 90670
Tel. 562-483-2740
Fax: 562-404-3999
WATS: 800-275-0028
losangeles@brightonbest.com

Maple Grove, MN

9060 Zachary Lane North
Ste. 111-116
Maple Grove, MN 55369
Tel. 763-425-9464
Fax: 763-425-9266
WATS: 800-275-0031
minnesota@brightonbest.com

Miami, FL

3426 West 84th St., Ste. 203
Hialeah, FL 33018
Tel. 305-512-3446
Fax: 305-512-3450
WATS: 800-275-0035
miami@brightonbest.com

Nashville, TN

446 Metroplex Dr. Ste. A120
Nashville, TN 37211
Tel. 615-834-1154
Fax: 615-834-1157
WATS: 800-275-0029
nashville@brightonbest.com

Portland, OR

13440 NE Jarrett St.
Portland, OR 97230
Tel. 503-261-0660
Fax: 503-252-4093
WATS: 800-275-0686
portland@brightonbest.com

Salt Lake City, UT

2179 S. Commerce Center Dr. Ste. 400
West Valley City, UT 84120
Tel: 801-972-1313
Fax: 801-972-5114
WATS: 800-935-1402
saltlake@brightonbest.com

San Francisco, CA

30964 San Benito Ct.
Hayward, CA 94544
Fax: 562-921-7191
WATS: 800-275-0028
sanfrancisco@brightonbest.com

Sayreville, NJ

200 Kennedy Dr.
Sayreville, NJ. 08872
Tel. 732-525-8400
Fax: 732-525-8408
sayreville@brightonbest.com

Seattle, WA

20308 59th Place South, Bldg. 1A
Kent, WA, 98032
Tel. 253-872-3417
Fax: 253-872-3415
WATS: 800-935-1502
seattle@brightonbest.com

St. Louis, MO

1856 Craig Rd.
St. Louis, MO 63146
Tel. 314-205-8001
Fax: 314-205-0857
WATS: 800-275-0047
stlouis@brightonbest.com

Tampa, FL

4915 Distribution Dr.
Tampa, FL 33605
Tel. 805-512-3446
Fax: 805-512-3450
WATS: 800-275-0035
tampa@brightonbest.com

CANADA

Montreal, Québec

5780 Kieran
Saint-Laurent, Québec H4S 2B5
Tel: 514-336-9888
Fax: 514-336-8865
WATS: 800-361-2076
montreal@brightonbest.com

Toronto, Ontario

7900 Goreway Dr., Unit 1
Brampton, Ontario L6T 5W6
Tel: 905-791-2000
Fax: 905-791-6841
WATS: 800-268-6918
toronto@brightonbest.com

Vancouver, British Columbia

9489 200 St, Unit 103&104
Langley, B.C. V1M 3A7
Tel: 604-513-0311
Fax: 604-513-0312
WATS: 800-663-9106
vancouver@brightonbest.com

AUSTRALIA

Brisbane, Queensland

11 Stradbroke St.
Heathwood, Queensland 4110
Tel. 617-3727-5700
Fax: 617-3714-9821
qldsales@brightonbest.com.au

Melbourne, Victoria

31-33 Canterbury Rd.
Braeside, VIC 3195
Tel. 613-8586-0244
Fax: 613-9587-7255
vicsales@brightonbest.com.au

Perth, Western Australia

Unit 3/420 Victoria Rd.
Malaga, Western Australia 6090
Tel. 618-6240-6800
Fax: 618-9248-4766
wasales@brightonbest.com.au

Sydney, New South Wales

6 Shale Place
Eastern Creek, NSW 2766
Tel. 612-8818-0900
Fax: 612-9620-1050
nswsales@brightonbest.com.au

NEW ZEALAND

Auckland, New Zealand

28B Pavillion Dr. Airport Oaks
Mangere, Auckland 2022
Tel. 649-257-5256
Fax: 649-257-5328
nzsales@brightonbest.co.nz

U.K.

Birmingham, West Midlands

Fastener Complex D1
Cradley Business Park,
Overend Rd., Cradley Heath
West Midlands B64 7DW
Tel. +44 (0) 1384-568144
Fax: +44 (0) 1384-413719
sales@brightonbest.org

BRAZIL

São Paulo, Brazil

Rua Dos Missionários, 410
São Paulo, Brazil 04729-001
Tel. 55 11-5641-4037
Fax: 55 11-5641-2444
luizab@brightonbest.com.br

MEXICO

Mexico

Toll Free: 1(855)-816-9726
Fax: 562-404-3999
mexico@brightonbest.com

Your Proffered® Authorized Distributor:

Global Headquarters

Tainan, Taiwan
No.122, Yi-Lin Road,
Rende Township,
Tainan, 71752 Taiwan
Tel. 886-6-270-1756
Fax: 886-6-270-6356
bbi-team@mail.tachen.com.tw

USA Headquarters

Long Beach, California
5855 Obispo Ave.
Long Beach, CA 90805
Tel. 562-808-8000
Fax: 562-808-8137
losangeles@brightonbest.com