



PRODUCT DATA SHEET

USA/CA: brightonBEST.com Europe: brightonBEST.org AU: brightonBEST.com.au NZ: brightonBEST.co.nz Brazil: brightonBEST.com.br

Pull Out Dowel Pins - Inch Series

1.0 Dimensions: As per manufacturer's standard.

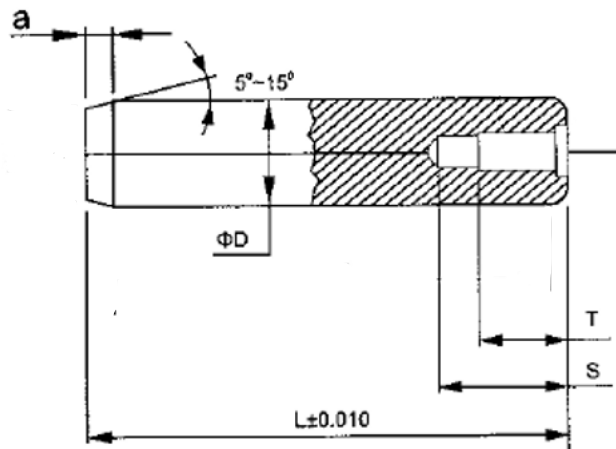

Nominal Size or Nominal Pin Diameter	Thread Size & Class of Fit	D		a	S	T
		Pin Diameter		Point Length	Drill Depth	Thread Depth
		Max	Min	Min	Max	Min
1/4	#8-32 UNC -2B	0.2503	0.2501	0.030	0.455	0.215
5/16	#10-32 UNF -2B	0.3128	0.3126	0.034	0.575	0.255
3/8	#10-32 UNF -2B	0.3753	0.3751	0.037	0.575	0.255
7/16	#10-32 UNF -2B	0.4378	0.4376	0.045	0.575	0.255
1/2	1/4 - 20 UNC-2B	0.5003	0.5001	0.045	0.660	0.350
5/8	1/4 - 20 UNC-2B	0.6253	0.6251	0.045	0.660	0.350
3/4	5/16 -18 UNC -2B	0.7503	0.7501	0.058	0.785	0.425
7/8	3/8-16 UNC -2B	0.8753	0.8751	0.058	0.785	0.425
1	3/8-16 UNC -2B	1.0003	1.0001	0.058	0.785	0.425

Hardness: Through hardened to 58/62 HRC

Surface Finish: Plain

Disclaimer: The above is a compilation of data, from various industry standards. BBI has taken every effort to present the data accurately. However BBI cannot be held liable for any claim traceable to any errors typographical or otherwise contained herein.